

FILIGRAN[®] - Punching shear reinforcement (FDB)
 pricelist 2021 (valid from 1st July 2021)

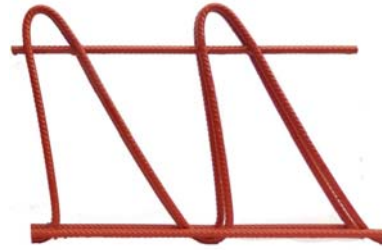

| Construction height | length | | |
|---------------------|--------|---------|---------|
| | 40 cm | 60 cm | 80 cm |
| 13 cm | 6,83 € | 10,13 € | 13,28 € |
| 14 cm | 6,93 € | 10,19 € | 13,39 € |
| 15 cm | 6,98 € | 10,29 € | 13,55 € |
| 16 cm | 7,04 € | 10,40 € | 13,65 € |
| 17 cm | 7,14 € | 10,50 € | 13,76 € |
| 18 cm | 7,19 € | 10,61 € | 13,91 € |
| 19 cm | 7,25 € | 10,71 € | 14,02 € |
| 20 cm | 7,30 € | 10,76 € | 14,12 € |
| 21 cm | 7,35 € | 10,87 € | 14,23 € |
| 22 cm | 7,40 € | 10,92 € | 14,33 € |
| 23 cm | 7,46 € | 10,97 € | 14,39 € |
| 24 cm | 7,51 € | 11,03 € | 14,44 € |
| 25 cm | 7,61 € | 11,18 € | 14,65 € |
| 26 cm | 7,67 € | 11,24 € | 14,70 € |
| 27 cm | 7,67 € | 11,29 € | 14,81 € |
| 28 cm | 7,72 € | 11,39 € | 14,86 € |
| 29 cm | 7,77 € | 11,39 € | 14,91 € |
| 30 cm | 7,77 € | 11,45 € | 14,96 € |

17.03.2021

All prices are subjected to VAT(within Germany)

All prices are EXW Lese. Transport mode and costs on request.

Pallets on Stock

FILIGRAN®-punching shear reinforcement **FDB**

mixed pallets (different lengths on pallet)

| Length | Construction height | |
|----------------|---------------------|-----------------|
| | FDB 13 - FDB 24 | FDB 25 - FDB 30 |
| 40 cm | 118 pcs / pallet | 59 pcs / pallet |
| 60 cm | 70 pcs / pallet | 35 pcs / pallet |
| 80 cm | 26 pcs / pallet | 13 pcs / pallet |
| Total quantity | 214 pcs = 110 m | 107 pcs = 55 m |

Quantity per pallet



unmixed pallet (only one length on pallet)

| Länge | Bauhöhe | |
|-------|----------------------------|----------------------------|
| | FDB 13 - FDB 24 | FDB 25 - FDB 30 |
| 40 cm | 240 pcs / pallet (96 m) | 120 pcs / pallet (48 m) |
| 60 cm | 160 pcs / pallet (96 m) | 80 pcs / pallet (48 m) |
| 80 cm | 120 pcs / pallet (96 m) | 60 pcs / pallet (48 m) |

Quantity per pallet